

How to use pre-filled syringes

REF: EV-VA0103BPP, EV-VA010 5BPP, EV-VA0110PP, EV-VA0103BF, EV-VA0105BF, EV-VA0110F

1

Take a pouch from the dispenser box and inspect it before opening to ensure it is intact, sealed, clean, and within its expiration date.

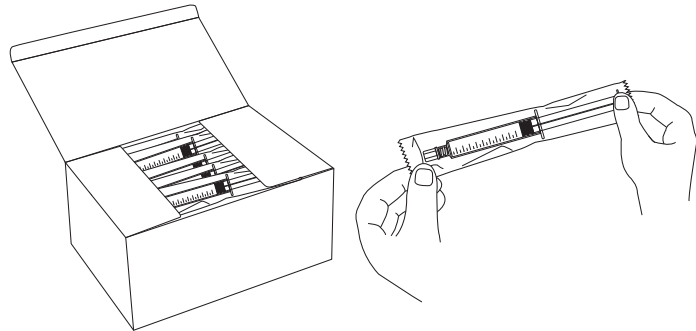

2

Open the pouch and remove the syringe. Visually inspect the product for particulate matter and discoloration prior to use according to warnings and precautions. Check that the syringe tip cap is in place. Inspect the clarity of the solution visually.

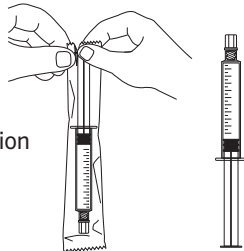

3

With the cap still on the syringe, depress the plunger slightly to release the stopper seal.

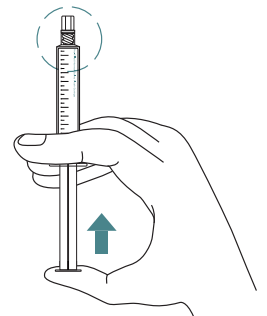

4

Unscrew the tip cap while it is still on the syringe. Ensure there is nothing that can contaminate the tip of the syringe before use.

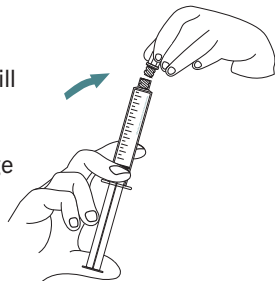

5

Push the syringe plunger to expel the air.

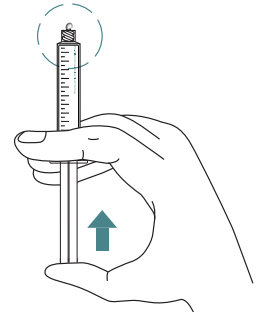

6

Connect the syringe to the vascular access device. Push the syringe plunger down to flush the required volume of saline following the local guidelines. In case of extreme plunger resistance, it is recommended not to exert excess force.

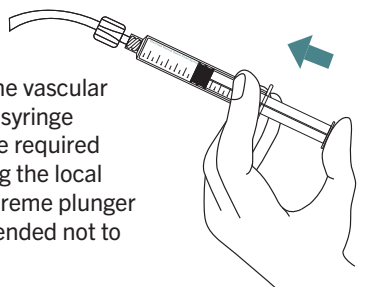

7

After use, dispose of the syringe, including any solution, in accordance with the local guidelines.

